



**ADDENDUM I**

**COMMITTEE OF THE WHOLE AGENDA**

**JUNE 16, 2014**

**ADDITION TO AGENDA**

- Item 5Bi. Illinois High-Speed Rail – Chicago to St. Louis – Impacts to Bloomington.  
(*Revised Presentation*)

# Illinois High-Speed Rail

Chicago to St. Louis

Impacts to Bloomington



Presented by Jim Karch  
Public Works Department



## Illinois High-Speed Rail Chicago to St. Louis

\$1.5 billion project to increase passenger train speed from 79 to 110 mph.

(All HSR improvement projects through Bloomington will be made at **no cost to the City.**)

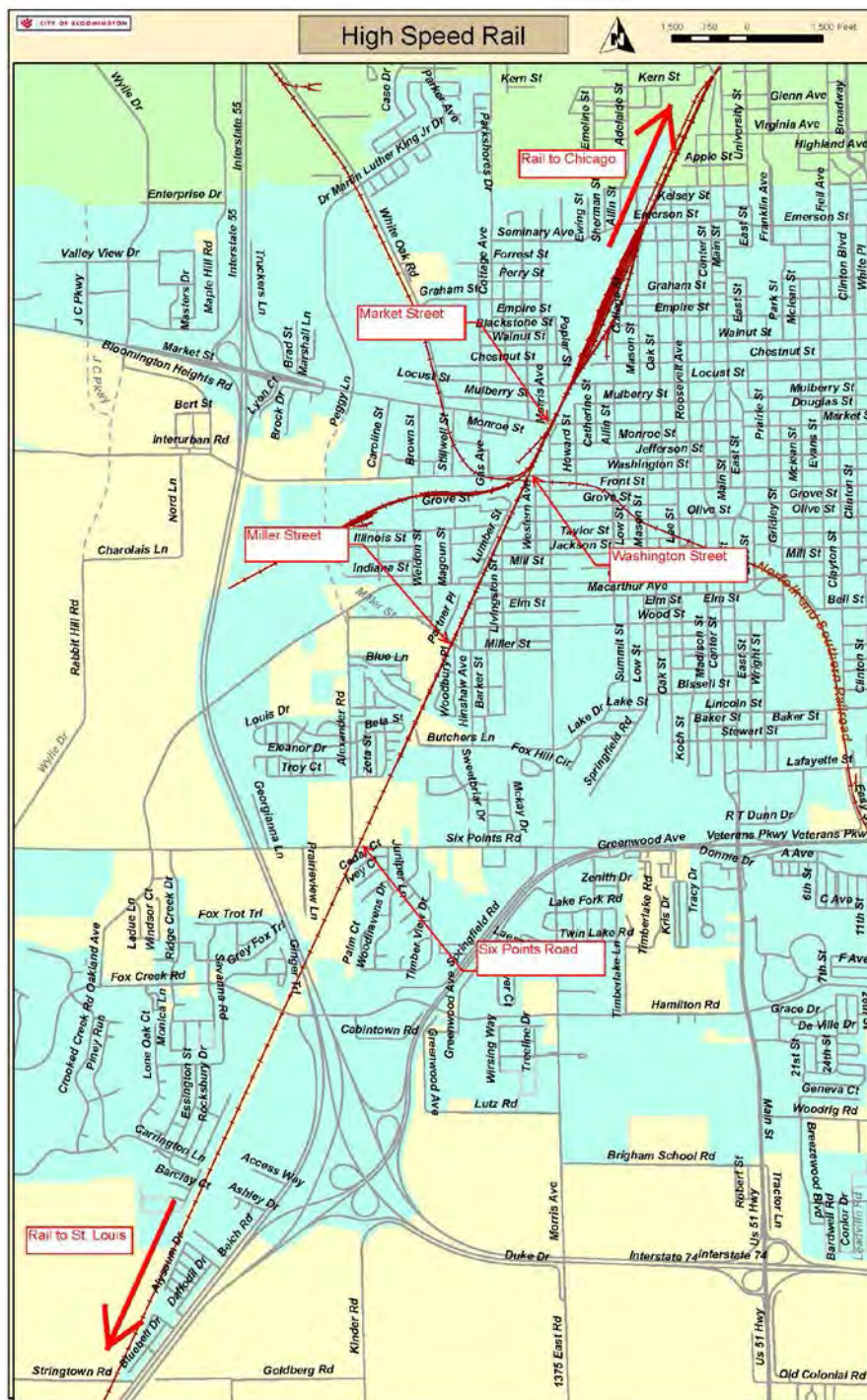

# Projects in Bloomington

## 1. Grade Separation Crossing

**Market Street** – Bridge replacement.

## 2. At Grade Crossings

**Washington Street** – New pedestrian crossing and vehicle gates.

**Miller Street** - New pedestrian crossing, upgraded vehicle gates, and street reconstruction.

**Six Points Road** – Vehicle gate upgrades and street reconstruction (no pedestrian crossing).

## 3. Fencing

New fencing nearly entire length of tracks through Bloomington.

# 1. Grade Separation



The existing structure at Market Street will be completely removed and replaced with a new bridge, along with street and traffic signal reconstruction.

# Grade Separation - New Market Street Bridge

Clear span improved from 33' to 44'

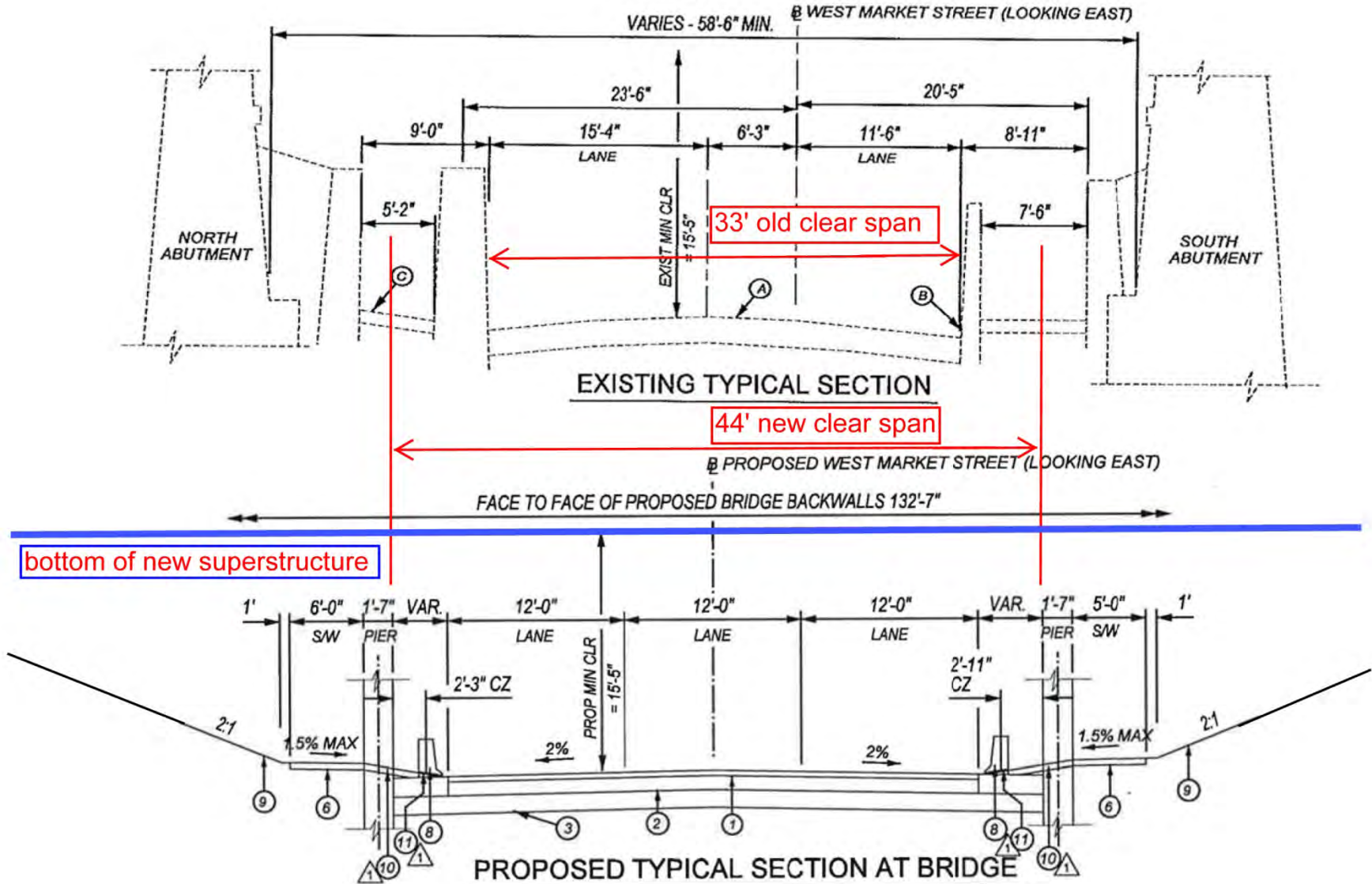

# Grade Separation - New Market Street Bridge

Construction is expected to begin late summer and may take up to one (1) year to complete. Traffic will be detoured onto Locust St. (US 150/IL Rte. 9).



# 2. At-Grade Crossings

## At-Grade Crossing (Washington Street)

**Washington Street** work includes a new gated pedestrian crossing on north side and new four quadrant roadway gates on the mainline track only. In a separate project (non-HSR) the next two street crossings to the west will also be improved, including future sidewalk.



Washington St., looking west.



# At-Grade Crossing (Washington & Miller St.)

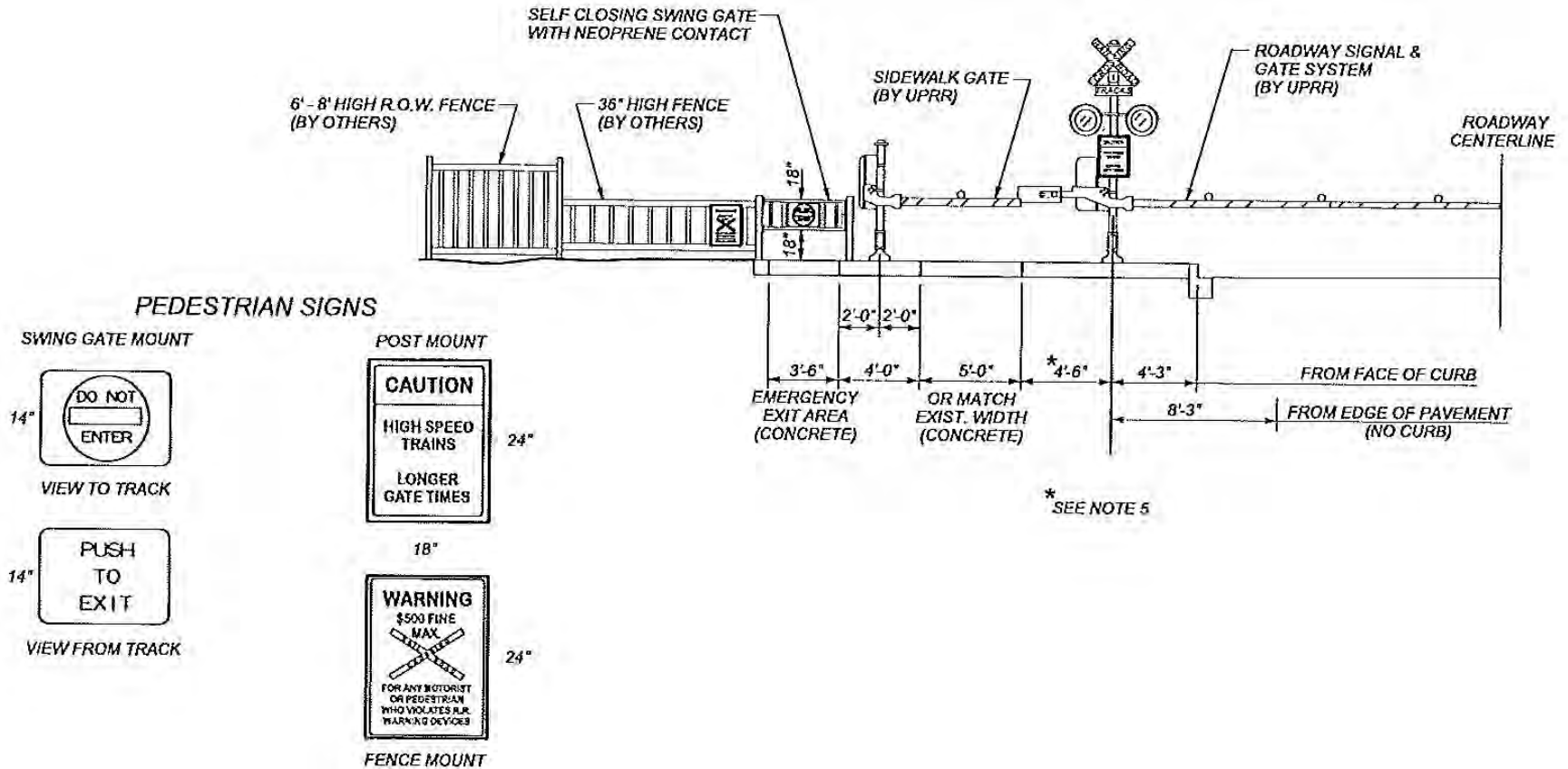

## PEDESTRIAN VIEW AT EXIT GATE - TRAIN APPROACHING

# At-Grade Pedestrian (Washington & Miller St.)



Typical pedestrian rail crossing installation

# At-Grade Crossing (Miller Street)

**Miller Street** work includes a new gated pedestrian crossing on north side and upgraded four quadrant roadway gates (just like Washington St.), and also street reconstruction to match grade of new track.



Miller St., looking west.

# At-Grade Crossing (Miller Street)

Miller Street roadway reconstruction limits (Partner Place to Pancake St.).

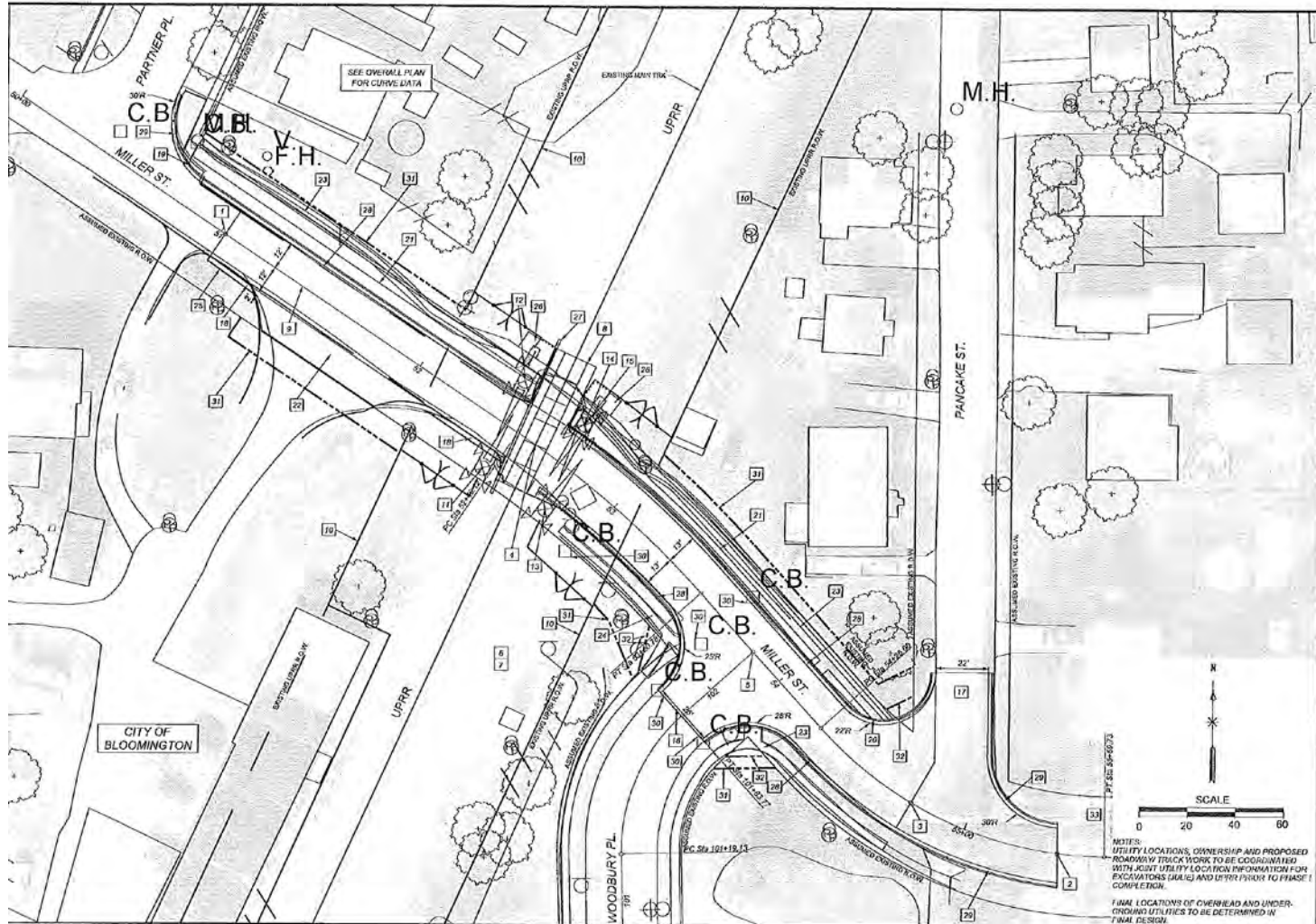

## At-Grade Crossing (Six Points Road)

**Six Points Road** work includes street reconstruction to match the grade of new track and upgraded four quadrant roadway gates. There is no pedestrian crossing at this location.



Six Pts. Rd., looking west.

# At-Grade Crossing (Six Points Road)

**Six Points Road** work includes street reconstruction (Alexander Rd to 100' east of RR r.o.w.) to match the grade of new track and upgraded four quadrant roadway gates. There is no pedestrian crossing at this location.

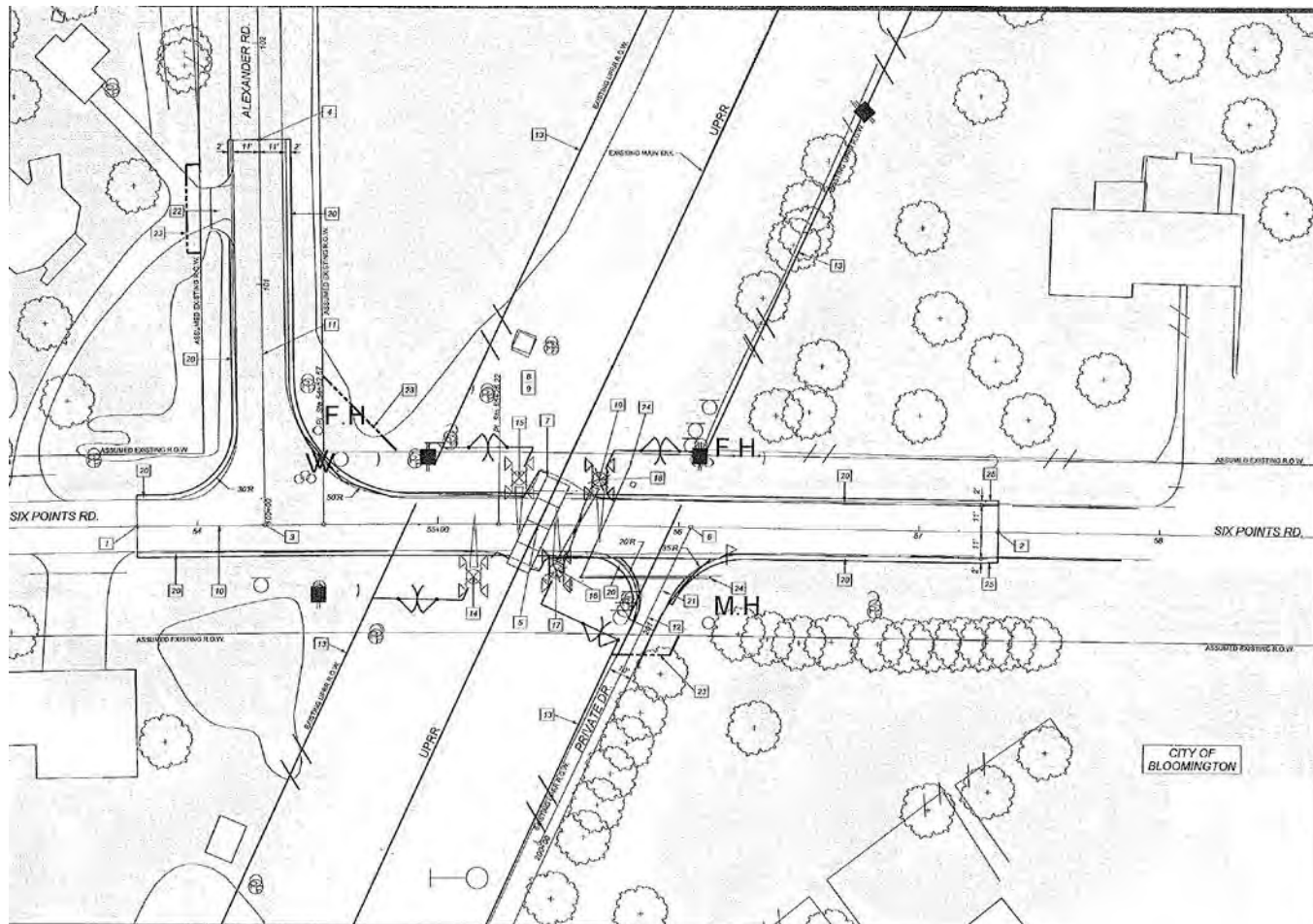

## At-Grade Crossing (all)

- At-Grade Crossing work will begin late summer and continue into 2015.
- No two consecutive crossings will be closed at the same time.
- Detours will not be provided for at-grade crossing work, as the traffic is more local, traffic volumes are lower than Market St., and construction at each location will be for a shorter duration (90 days +/-) than the Market St. bridge replacement.
- Pavement reconstruction will include new concrete curb and new asphalt pavement from curb to curb.

# 3. Fencing

HSR fencing will consist of 3, 6 & 8 ft. decorative fencing in residential areas and 6 ft. chain link fence in commercial and rural areas. Nearly the entire corridor through Bloomington will be fenced on both sides of the tracks. Most fence installation will occur after the grade crossings are completed.





## Fencing (general)

- The HSR Project team will be individually contacting property owners affected by fencing work.
- The HSR Project preference is to remove private fence that is parallel to the tracks and replace it with HSR fencing, 1' onto RR r.o.w., and tie in perpendicular private fence to the HSR fence.
- The HSR Project will make accommodations to individual properties for pet safe fence.
- The City Public Works Dept. intends to coordinate an open public meeting with assistance from the IDOT / HSR Public Information Group. (mid to late summer)

Questions?